

Lutron's Most Popular Dimmer is Now Smart

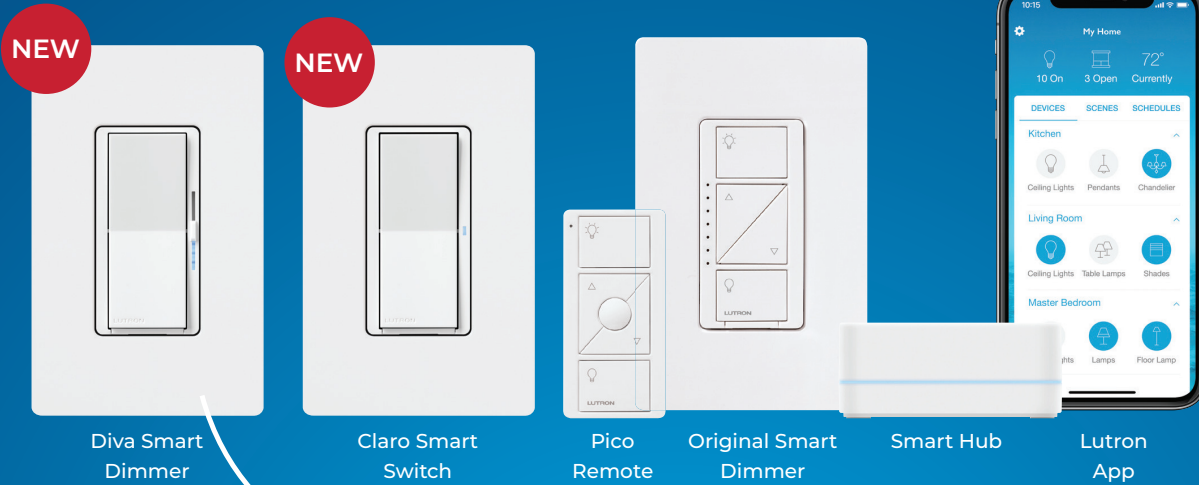

Introducing the Diva Smart Dimmer and the Claro Smart Switch – a new look for the Caséta family

Intuitive design that offers simplicity, style, and control

- Additional designer style to coordinate with your customers' existing paddle switches
- Signature Diva and Claro lighting controls with built-in smart technology
- Easy-to-install with wired and wireless 3-way options

The Caséta Advantage — Comfort, Control, and Peace of Mind

- Customized schedules allow customers to always come back to a well-lit home
- Personalized scene control to set the mood for any occasion
- Multiple points of control from virtually anywhere — remote, app, switch, or voice

Caséta by **LUTRON**

Most connected – works with more smart-home devices than any other smart lighting brand

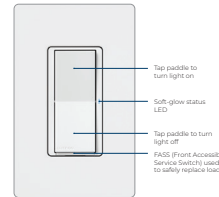

NEW
Lutron Caséta
Claro Smart Switch

- Turns wired lights or ceiling/exhaust fans on and off
- Replaces existing light switch
- Wired or wireless 3-way/multi-location capable for control from 2 or more locations
- Neutral wire required
- Compatible with the Original Caséta family of products and the Lutron Smart Hub (formerly Smart Bridge)

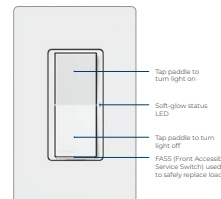

NEW
Lutron Diva
Smart Dimmer

- 1 hardwired in-wall smart dimmer (not rated for low voltage lighting such as certain track lighting or landscape lighting)
- LED+ technology for superior dimming of LEDs
- No neutral wire required
- Wired or wireless 3-way/multi-location capable for control from 2 or more locations
- Compatible with the Original Caséta family of products and the Lutron Smart Hub (formerly Smart Bridge)



Lutron Caséta Diva
Smart Dimmer Starter
kit, with Smart Hub
and Pico Remote

- Easy and precise dimming control
- LED technology provides superior LED dimming
- Intuitive on/off paddle
- Sleek slider for accurate dimming with a soft glow bar
- Lutron Clear Connect RF Technology works through walls and floors